

Flushing Pressure Indicator Nozzle

GPH Irrigation

Our FN series flush nozzles combines the function of a drip flush valve with a colored nozzle (orange or purple) to give maintenance persons a visual indication of the drip system coverage areas. The flush nozzle easily installs on any pop up spray body allowing for the maintenance persons to quickly locate the flush valves instead of searching in dense ground covers for boxes below grade. Also, given the simplicity of the installation and cost of the components, this will be a much less expensive flush valve then currently available. This nozzle will is available in two styles, Rain Bird threaded or Toro threaded, as well as a bright orange color for potable water systems and a purple color for use on recycled water systems.

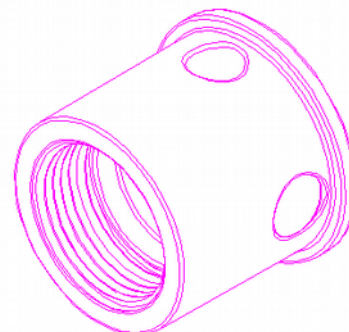

Part #:	Description:
GDFN	Drip Flush Nozzle, Rain Bird style female threads, Orange in color.
GDFN-T	Drip Flush Nozzle, Toro style male threads, Orange in color.
GDFN-R	Drip Flush Nozzle, Rain Bird style female threads, Purple in color.
GDFN	Drip Flush Nozzle, Toro style male threads, Purple in color.

GPH Irrigation
8031 Redwood Ave.
Fontana, CA 92336
866.582.9684
www.gphirrigation.com